

# Exploded

E3047 VERTICAL KNESS UP/DIP

please note :prats didn't demolitionde part and fast  
eners not listde on the introduction

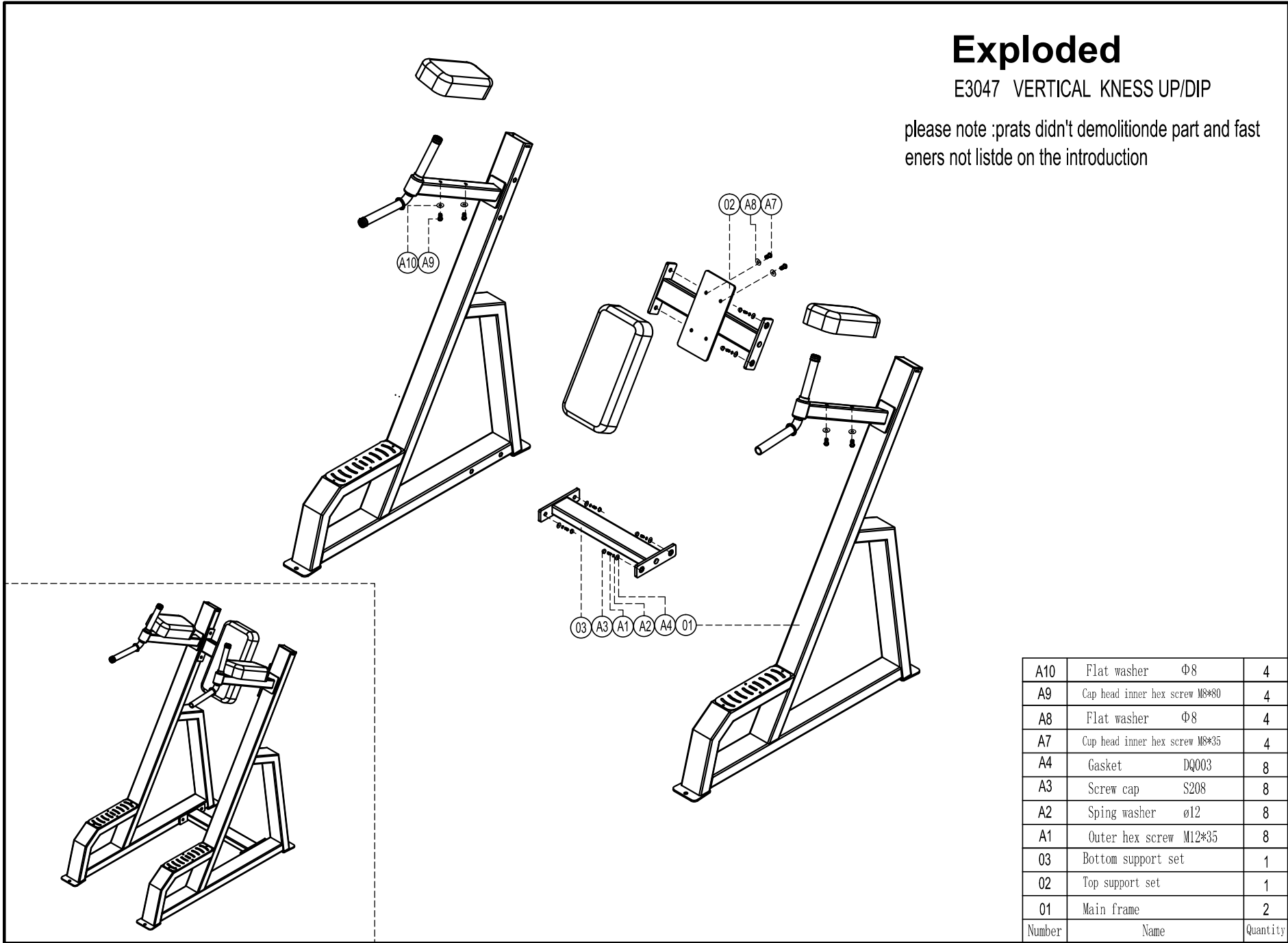

A10	Flat washer	Φ8	4
A9	Cap head inner hex screw	M8*80	4
A8	Flat washer	Φ8	4
A7	Cup head inner hex screw	M8*35	4
A4	Gasket	DQ003	8
A3	Screw cap	S208	8
A2	Sping washer	ø12	8
A1	Outer hex screw	M12*35	8
03	Bottom support set		1
02	Top support set		1
01	Main frame		2
Number	Name		Quantity